

Safety Roller (GS-G506-TL4)

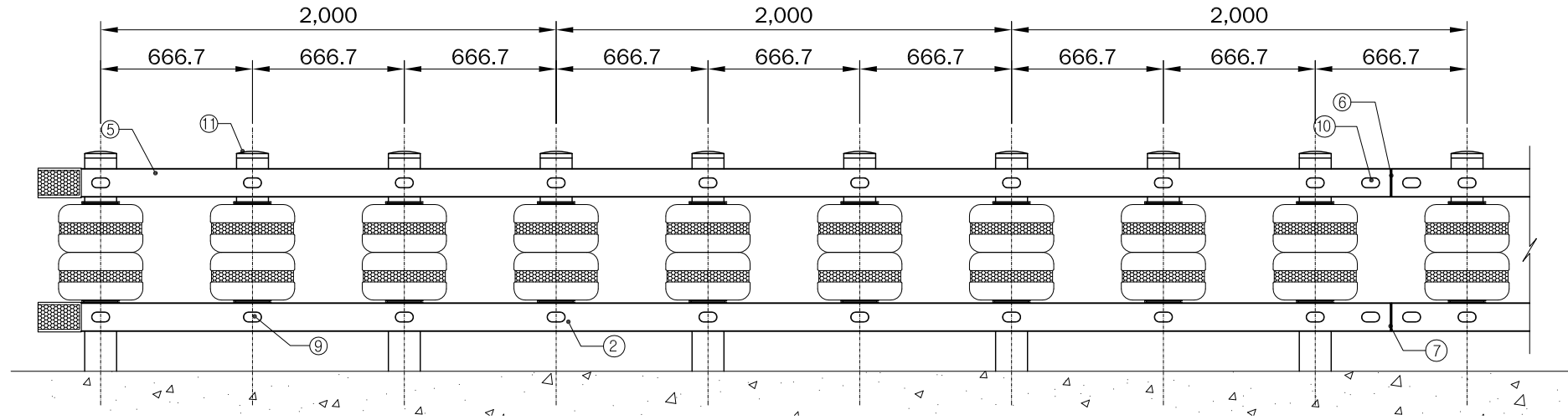

ELEVATION

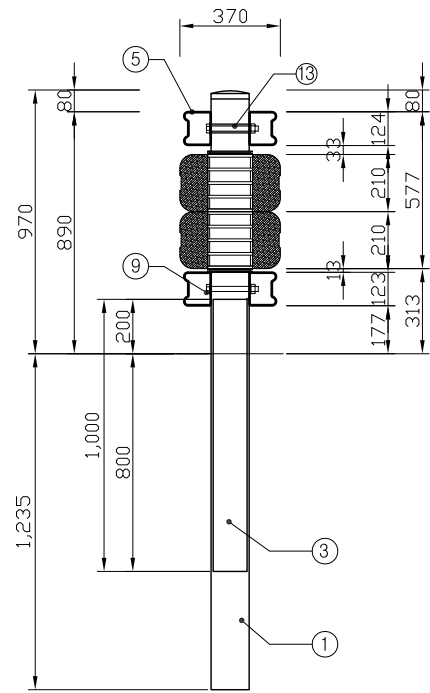
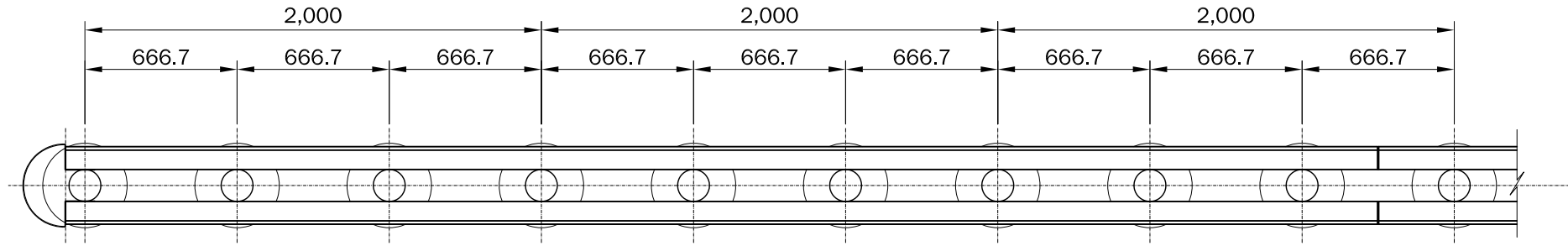

TOP VIEW

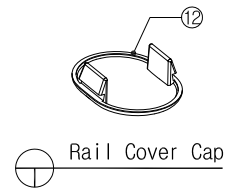

Rail Cover Cap

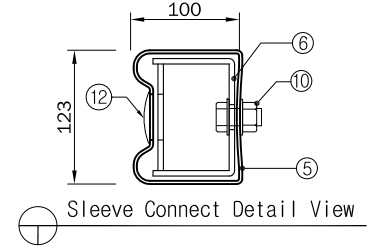

Sleeve Connect Detail View

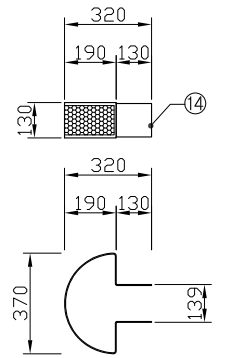

Round Rail Detail View

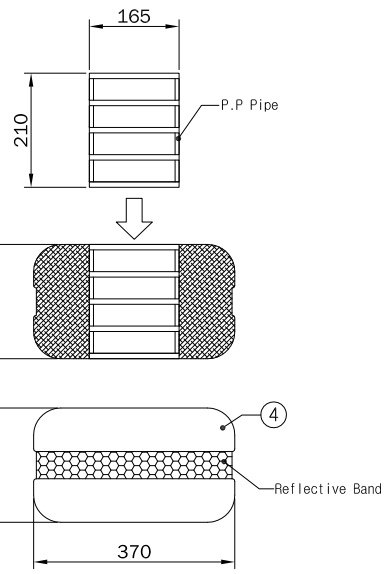

Shock Absorbing Roller Detail View

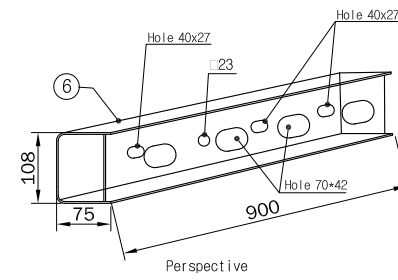

Sleeve Detail View

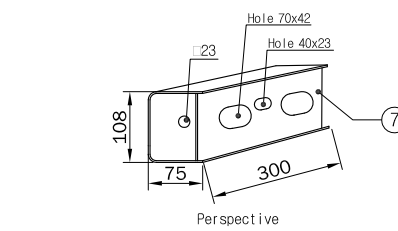

Sleeve Detail View

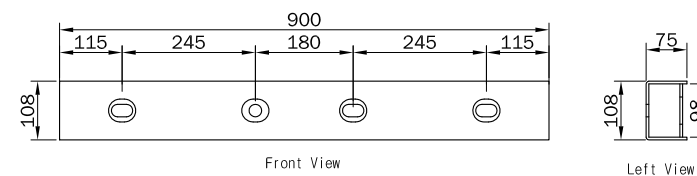

Front View Left View

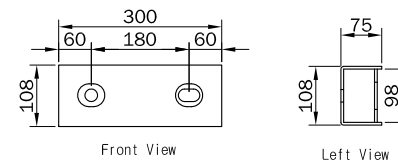

Front View Left View

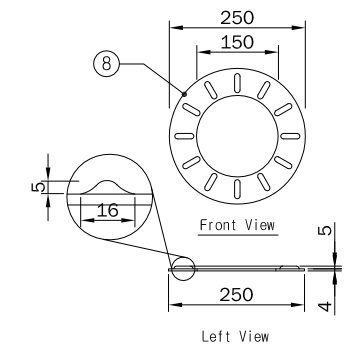

Stopper Board(9T)

Material List

(1 SPAN : 2M)

NO	PRODUCT	STANDARD	UNIT	QUANTITY	비 고
①	Post (SS400)	□139.8 x 2200L x 4.5T	EA	1.5	Hot Dipp Galv.
②	Post (SS400)	□139.8 x 780L x 4.5T	EA	1.5	Hot Dipp Galv.
③	Inner Post (SS400)	□125 x 1000L x 4.3T	EA	1.5	Hot Dipp Galv.
④	Shock Absorbing Roller	□370 x 210	EA	6	E.V.A
		P.P Pipe	EA	6	P.P
		Reflective Band	EA	6	Reflective Sheet
⑤	Safety Rail (SS400)	123x100x5.995x3.0T	M	8	Hot Dipp Galv.
⑥	Sleeve Rail (SS400)	108x75x900x5.0T	EA	0.67	Hot Dipp Galv.
⑦	Sleeve Rail (SS400)	108x75x300x5.0T	EA	0.67	Hot Dipp Galv.
⑧	Stopper Board	□250 x 9T	EA	12	P.E
⑨	H-Bolt/Nut/H-Washer	□19 x 200L	EA	6	Hot Dipp Galv.
⑩	H-Bolt/Nut/H-Washer	□16 x 40L	EA	2.67	Hot Dipp Galv.
⑪	Post Cap	□139.8	EA	3	Hot Dipp Galv.
⑫	Rail Cover Cap	80 x 45	EA	14.7	P.E
⑬	Pipe (SS400)	□34 x 125L x 4.0T	EA	3	Hot Dipp Galv.
⑭	Round Rail	370x320x130x3.2T	EA	1	Hot Dipp Galv.

* Allow ±10% of tolerance in spec. such as size, thickness, length and width of material listed above.

PROJECT TITLE

DWG TITLE

Safety Roller (GS-G506-TL4)

KSI Ltd.
www.ksikorea.com

CONSULT

CHECK

DESIGN

DRAWN

DATE

SCALE

DRAWING NO.

SHEET NO

2/2